



TIRE PRESSURE MONITORING SYSTEM GUIDE

PROGRAMMING A NEW TPMS SENSOR

NOTE: ALWAYS PROGRAM NEW SENSORS BEFORE INSTALLATION. DO NOT PROGRAM SENSORS INSIDE THE WHEEL.

Whenever replacing damaged TPMS sensors, the new ones will need to be programmed to match that specific vehicle. Use the TPMS tool to program the new sensor, and install it into the wheel. Once the sensor has been installed, perform the TPMS relearn procedure outlined in the tool's relearn instructions.

SECTION 1.

PROGRAMMING THE SENSOR

1



Select a new sensor that matches the style of the original sensor's valve stem.

2

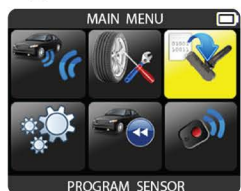

► Make
► Model
► Year

From the tool's main menu, select "Program Sensor". Then select the vehicle's make, model, and year.

3

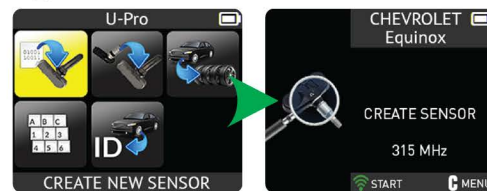

From the Program Sensor menu, select "Create New Sensor". The tool will then display the sensor creation screen.

4



Place the sensor above the tool's antenna and press the green trigger button.

5



After a few moments, the new sensor will have been programmed to match that vehicle.

6



Now that the new sensor is programmed, uninstall the original sensor and install the new sensor.

SECTION 2.

RELEARNING THE VEHICLE

1



Before performing a relearn, ensure the new sensor(s) are properly installed, and the wheel(s) have been put back on.

2



► Make
► Model
► Year

From the tool's main menu, select "Service TPMS". Then select the vehicle's make, model, and year.

3

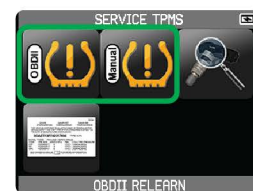

The service menu will display one or more relearn options, "OBDII" and "Manual". (See other side/next page, for further explanation).



TIRE PRESSURE MONITORING SYSTEM GUIDE

TPMS RELEARN PROCEDURES



NOTE: MANY VEHICLES WILL REQUIRE THAT IT BE DRIVEN FOR A CERTAIN TIME AFTER THE RELEARN. REFER TO THE TOOL'S LISTED INSTRUCTIONS.



OBDII Relearn

Some vehicles supported by the tool offer the ability to perform an OBDII relearn, a relearn procedure that requires use of the OBDII cable. Simply scan each sensor, connect the cable, and transfer the sensor information to the ECU.

1

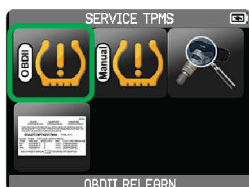

From the service menu, select “OBDII Relearn”.

2



The tool will display the order in which to trigger each sensor, press OK to continue to the relearn screen.

3

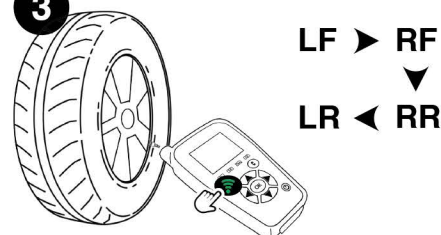

Trigger each sensor around the vehicle, in the listed order, pressing the green trigger button at each sensor.

4

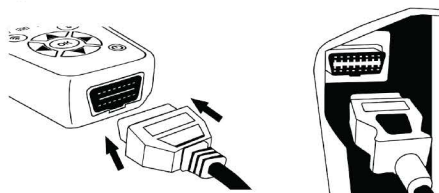

Turn the vehicle's ignition to the ON position, and connect the OBDII cable to the tool and the other end to the vehicle.

5

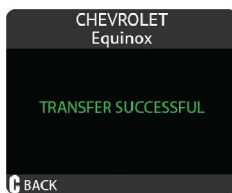

Once connected, press OK. The tool will then transfer the new sensor information to the vehicle.

Manual Relearn

Vehicles that do not support the OBDII relearn function will need to manually be put into a “learn mode”. The tool will display a set of steps to put the vehicle into this mode. Once activated, each sensor will need to be triggered.

1

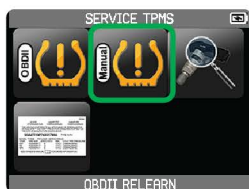

From the service menu, select “Manual Relearn”.

2

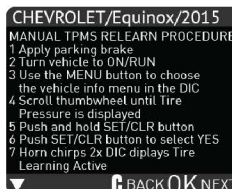

The tool will display a list of instructions, follow each step and once complete, many vehicles will display that it is in a learn mode, or the horn will honk twice.

3

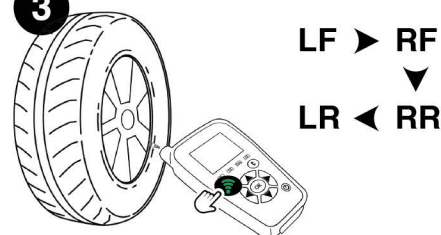

Trigger each sensor around the vehicle, in the listed order, pressing the green trigger button at each sensor.

Manual Relearn (Auto)

Many vehicles have an “Auto” type of Manual Relearn. The instructions will say to simply trigger each sensor after it has been installed, and then drive the vehicle for a certain amount of time. Meaning that the vehicle does not need to be put into a “learn mode” in order to relearn each sensors’ information and location.